



## Case History TRANSFER STATION UPGRADE

SPERLING  
HANSEN  
ASSOCIATES

### Design Project, City of Vancouver

- **City of Vancouver is Upgrading Entrance and Transfer Station/Recycling Facilities**
- **Project was part of Closure Design a portion of the landfill**
- **SHA designed conceptual layout of Entrance, Recycling Area, Scale Facility and Free Recycling Drop Off Area.**
- **Project currently under design review.**

**City of Vancouver Contact: Paul Henderson**

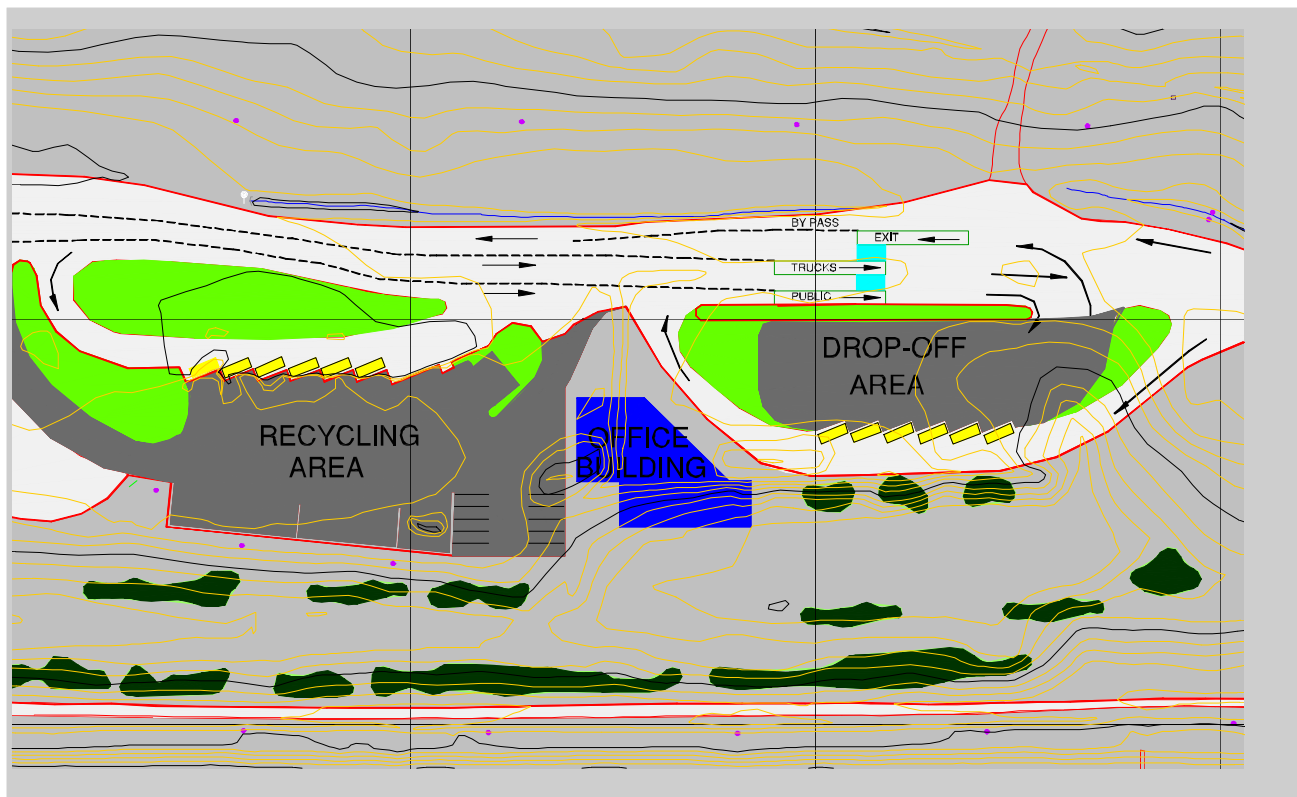

**SPERLING HANSEN ASSOCIATES**  
#8 1225 East Keith Road, North Vancouver, B.C.  
Phone (604) 986-7723 Fax (604) 986-7734  
E-Mail: [sperling@sperlinghansen.com](mailto:sperling@sperlinghansen.com)

- **Landfill Siting**
- **Landfill Closure**
- **Hydrogeological Investigation**
- **Environmental Monitoring**
- **Design and Operations Plans**